

Avdelmate® SSLMS

For installation information please refer to the tooling overview and manuals on our website www.avdel-global.com.
 Pour les conditions de pose, merci de vous référer à la description de l'outil et aux manuels disponibles sur notre site Web.
 Angaben zur Verarbeitung entnehmen Sie bitte der Geräteübersicht und den Betriebsanleitungen auf unserer Website.
 Per informazioni sull'installazione preghiamo consultare i manuali e la panoramica degli attrezzi sul nostro sito web.
 Para ver información sobre máquinas de colocación, consulte nuestra página web, apartados visión general de máquinas y manuales.

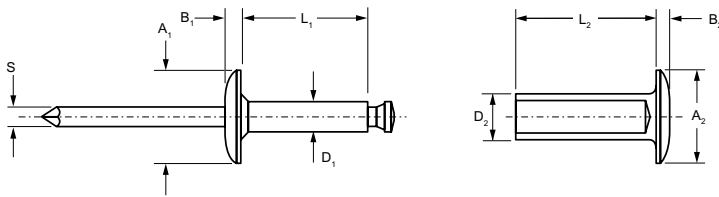

English	Français	Deutsch	Italiano	Español
Body: Steel Zinc plated	Corps: Acier Revêtement zingué	Hülse: Stahl Verzinkt	Corpo: Acciaio Zincati	Cuerpo: Acero Zincado
Mandrel: Steel Zinc plated	Tige: Acier Revêtement zingué	Dorn: Stahl Verzinkt	Gambo: Acciaio Zincati	Vástago: Acero Zincado
Tubular Component: Steel Zinc plated	Composant tubulaire: Acier Revêtement zingué	Röhrenförmiges Gegen- stück: Stahl Verzinkt	Componente tubulare: Acciaio Zincati	Componente tubular: Acero Zincado



ø nom.	[Cross-section diagram]		D ₁	L ₁ max.	A ₁	B ₁	S	D ₂	L ₂ max.	A ₂	B ₂	[Cross-section diagram]	Part No/ref
	min.	max.											
3/16" (4.8 mm)	.625	.750	.250	.125	.525	.375	.059	.076	.188	.375	.057	N/A	SSLMS-06SP-12
	.688	.875											SSLMS-06SP-14
	.875	1.063											SSLMS-06SP-17
	1.063	1.250											SSLMS-06SP-20
	1.250	1.438											SSLMS-06SP-23
	1.438	1.625											SSLMS-06SP-26
	1.625	1.813											SSLMS-06SP-29
	1.813	2.000											SSLMS-06SP-32
	2.000	2.188											SSLMS-06SP-35
	2.188	2.375											SSLMS-06SP-38
1/4" (6.4 mm)	.625	.750	.312	.187	.442	.625	.095	.114	.250	.625	.095	350	SSLMS-08SP-12
	.750	.875											SSLMS-08SP-14
	.875	1.125											SSLMS-08SP-18
	1.125	1.375											SSLMS-08SP-22
	1.375	1.625											SSLMS-08SP-26
	1.625	1.875											SSLMS-08SP-30
	1.875	2.125		SSLMS-08SP-34									
	2.125	2.375		SSLMS-08SP-38									
	2.375	2.625		SSLMS-08SP-42									
	2.625	2.875		SSLMS-08SP-46									
	2.875	3.125		SSLMS-08SP-50									
	3.125	3.375		SSLMS-08SP-54									
	3.375	3.625		SSLMS-08SP-58									
	3.625	3.875		SSLMS-08SP-62									

all dimensions in inches / en pouces / alle Maße in Zoll / in pollici / en pulgadas

1) typical values / valeurs moyennes / typische Werte / Valori tipici / resistencias máximas recomendadas

