

# Avsert® 1117



For installation information please refer to the tooling overview and manuals on our website [www.avdel-global.com](http://www.avdel-global.com).  
 Pour les conditions de pose, merci de vous référer à la description de l'outil et aux manuels disponibles sur notre site Web.  
 Angaben zur Verarbeitung entnehmen Sie bitte der Geräteübersicht und den Betriebsanleitungen auf unserer Website.  
 Per informazioni sull'installazione preghiamo consultare i manuali e la panoramica degli attrezzi sul nostro sito web.  
 Para ver información sobre máquinas de colocación, consulte nuestra página web, apartados visión general de máquinas y manuales.

English	Français	Deutsch	Italiano	Español
Short spigot	Pion court	Kurzer Schaft	Piedino corto	Espiga corta
Brass*	Laiton*	Kupfer-Zink Legierung*	Ottone*	Latón*
Tin plated**	Étamé**	verzinkt**	Stagnato**	Estañado**

\*: CuZn38Pb1.5 (ROHS conform)

\*\* : ROHS conform; Avdel recommends tin plated parts are installed within 24 months from the date they were produced / Avdel conseille d'utiliser les pièces en laiton étamé sous un délai de 24 mois après la date de production / Avdel empfiehlt, verzinnte Nieten innerhalb 24 Monaten nach Produktionsdatum zu verarbeiten / Avdel raccomanda di utilizzare i prodotti stagnati entro 24 mesi a decorrere dalla data di fabbricazione/ Avdel recomienda utilizar sus piezas estañadas antes de 24 meses desde la fecha de su fabricación.

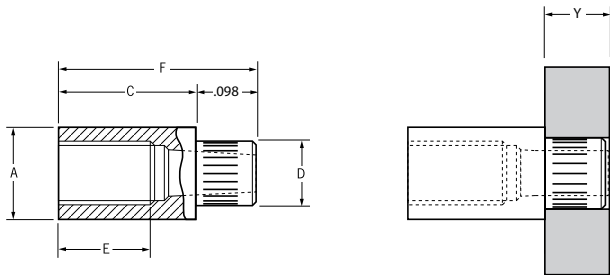

ø	Y		Drill Bit		A	C	D	E	F	Torque lbf in max. <sup>1)</sup>	Fasteners per pod/ Nombre de rivets par chargeur/ Niete pro Magazin/ Rivetti per carica- tore / Uds./carga	Part No/ref	
	nom.	min.	max.	min.									max.
M2.5 x 0.45	.032	.079	.106	.110	.159	.217	.106	.134	.315	7.52		36	01117-06555
						.236		.153	.334			34	01117-06560
						.276		.193	.374			30	01117-06570
						.315		.232	.413			27	01117-06580
						.354		.232	.458			25	01117-06590
M3 x 0.5	.032	.079	.130	.134	.191	.217	.129	.134	.315	12.21		36	01117-07055
						.236		.153	.334			34	01117-07060
						.276		.193	.374			30	01117-07070
						.315		.232	.413			27	01117-07080
						.354		.232	.458			25	01117-07090

all dimensions in inches / en pouces / alle Maße in Zoll / in pollici / en pulgadas

1) As tested in .059" thick glass fibre reinforced board to specification NEMA-L11-1971 Type FR4.

Testé dans circuit imprimé fibre / époxy 15/10 selon NEMA-L11-1971 type FR4.

Getestet in .059" starker glasfaserverstärkter Leiterplatte nach Spezifikation NEMA-L11-1971 Typ FR4.

Testato in un circuito rinforzato con fibra di vetro di .059" come da specifica NEMA-L11-1971 tipo FR4.

Testado en una tarjeta reforzada con fibra de vidrio de .059".



[www.avdel-global.com](http://www.avdel-global.com)

© 2010 Infastech

Avsert® is a trademark of Avdel UK Limited

05c.2007

Data shown is subject to change without prior notice as a result of continuous product development and improvement policy.  
 Your local Avdel representative is at your disposal should you need to confirm latest information.