

Chobert® 1121



For installation information please refer to the tooling overview and manuals on our website www.avdel-global.com.
 Pour les conditions de pose, merci de vous référer à la description de l'outil et aux manuels disponibles sur notre site Web.
 Angaben zur Verarbeitung entnehmen Sie bitte der Geräteübersicht und den Betriebsanleitungen auf unserer Website.
 Per informazioni sull'installazione preghiamo consultare i manuali e la panoramica degli attrezzi sul nostro sito web.
 Para ver información sobre máquinas de colocación, consulte nuestra página web, apartados visión general de máquinas y manuales.

English	Français	Deutsch	Italiano	Español
Dome head	Tête plate	Flachrundkopf	Testa tonda	Cabeza alomada
Low carbon steel*	Acier bas carbone*	Stahl*	Acciaio a basso tenore di carbonio*	Acero bajo en carbono*
Zinc plated	Revêtement zingué	Verzinkt	Zincato	Zincado
Clear trivalent passivated	Passivation claire trivalente	Klar chromatiert, Cr6-frei	Passivazione chiara trivalente	Pasivado claro trivalente

*: SAE 1008 / EN 10263-2 C8C (DIN 10263-2 C8C, Qst 34-3)

Option:

120° countersunk head. Replace part no. 01121 with 01122 for equivalent grip range. A, B and C dimensions may vary, details on request.
 120° tête fraisée. Remplacer la série 01121 par 01122 avec plage de serrage équivalent. Dimensions A, B et C peut différer. Détails sur demande.
 120° Senkkopf. Ersetzen Sie 01121 durch 01122 - bei äquivalentem Klemmbereich können Abmessungen A, B und C abweichen, Details auf Anfrage.
 120° testa svasata: sostituire 01121 con 01122 per campo dello spessore serrabile equivalente. Dimensioni A, B e C possono variare. Dettagli su richiesta.
 120° cabeza avellanada: cambiar 01121 por 01122 para espesores a remachar equivalente. Las dimensiones A, B y C pueden variar. Más información bajo petición.

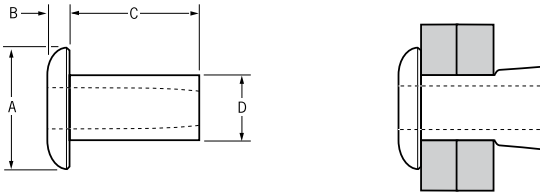

Ø	Ø		Ø		A	B	C	D	lb ^{f1)}	Fasteners per pod/ Nombre de rivets par chargeur / Niete pro Magazin/ Rivetti per carica- tore / Uds./carga	Part No/ref	
	min.	max.	min.	max.								min.
1/8"	.000	.062	.129	.132	.215	.044	.125	.128	314	± 1	71	01121-00404
	.031	.093					.156			57	01121-00405	
	.062	.125					.187			51	01121-00406	
	.125	.187					.250			39	01121-00408	
	.187	.250					.312			32	01121-00410	
	.250	.312					.375			27	01121-00412	
	5/32"	.062					.125			.161	.164	.255
.125		.187	.250	38	01121-00508							
.187		.250	.312	31	01121-00510							
.250		.312	.375	27	01121-00512							
.312		.375	.437	23	01121-00514							
.375		.437	.500	21	01121-00516							

all dimensions in inches / en pouces / alle Maße in Zoll / in pollici / en pulgadas

1) typical values / valeurs moyennes / typische Werte / Valori tipici / resistencias máximas recomendadas



An Acument™ Global Technologies Company

www.avdel-global.com



© 2007 Acument Intellectual Properties, LLC

Chobert® is a trademark of Avdel UK Limited

04.2008, page 1/2

Data shown is subject to change without prior notice as a result of continuous product development and improvement policy.
 Your local Avdel representative is at your disposal should you need to confirm latest information.

Chobert® 1121

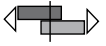
Ø					A	B	C	D		Fasteners per pod/ Nombre de rivets par chargeur / Niete pro Magazin/ Rivetti per carica- tore / Uds./carga	Part No/ref
	nom.	min.	max.	min.	max.	max.	max.	nom.	max.		
3/16"	.000	.062	.191	.194	.349	.070	.157	.191	719	50	01121-00605
	.062	.125								38	01121-00607
	.125	.187								33	01121-00609
	.187	.250								28	01121-00611
	.250	.312								24	01121-00613
	.312	.375								21	01121-00615
	.375	.437								19	01121-00617
	.437	.500								17	01121-00619
1/4"	.125	.187	.250	.253	.411	.083	.281	.250	989	32	01121-00809
	.187	.250								27	01121-00811
	.250	.312								24	01121-00813
	.312	.375								21	01121-00815
	.375	.437								19	01121-00817
	.437	.500								17	01121-00819

all dimensions in inches / en pouces / alle Maße in Zoll / in pollici / en pulgadas

1) typical values / valeurs moyennes / typische Werte / Valori tipici / resistencias máximas recomendadas



An Acument™ Global Technologies Company

www.avdel-global.com

© 2007 Acument Intellectual Properties, LLC

Chobert® is a trademark of Avdel UK Limited

04.2008, page 2/2

Data shown is subject to change without prior notice as a result of continuous product development and improvement policy.
Your local Avdel representative is at your disposal should you need to confirm latest information.