

# Chobert® 1131



For installation information please refer to the tooling overview and manuals on our website [www.avdel-global.com](http://www.avdel-global.com).  
 Pour les conditions de pose, merci de vous référer à la description de l'outil et aux manuels disponibles sur notre site Web.  
 Angaben zur Verarbeitung entnehmen Sie bitte der Geräteübersicht und den Betriebsanleitungen auf unserer Website.  
 Per informazioni sull'installazione preghiamo consultare i manuali e la panoramica degli attrezzi sul nostro sito web.  
 Para ver información sobre máquinas de colocación, consulte nuestra página web, apartados visión general de máquinas y manuales.

English	Français	Deutsch	Italiano	Español
Dome head	Tête plate	Flachrundkopf	Testa tonda	Cabeza alomada
Aluminium alloy* (3.5 % Mg)	Alliage d'aluminium* (3.5% Mg)	Aluminium* (3.5 % Mg)	Lega di alluminio* (3.5% Mg)	Aluminio* (3.5% Mg)
Natural	Brut	Blank	Nessuna finitura	Natural

\*: BS 1473 5154A DIN 1725 AlMg3.5 Werkstoff 3.3535

#### Options:

2.5 % Mg aluminium alloy: replace part no. 01131 with 01125, please note reduction in shear strength, details on request.  
 120° countersunk head: replace part no. 01131 with 01132 for equivalent grip range. A, B and C dimensions may vary, details on request.  
 2.5 % Mg alliage d'aluminium: remplacer la série 01131 par 01125, veuillez respecter réduction en cisaillement, détails sur demande.  
 120° tête fraisée: remplacer la série 01131 par 01132 avec plage de serrage équivalent. Dimensions A, B et C peut différer. Détails sur demande.  
 2.5 % Mg Aluminium-Legierung: ersetzen Sie 01131 durch 01125, bitte beachten Sie eine Reduktion der Scherfestigkeit, Details auf Anfrage.  
 120° Senkkopf: ersetzen Sie 01131 durch 01132 - bei äquivalentem Klemmbereich können Abmessungen A, B und C abweichen, Details auf Anfrage.  
 2.5 % Mg lega di alluminio: sostituire 01131 con 01125, notare la riduzione della resistenza a taglio, Dettagli su richiesta.  
 120° testa svastata: sostituire 01131 con 01132 per campo dello spessore serrabile equivalente. Dimensioni A, B e C possono variare. Dettagli su richiesta.  
 Aluminio (2,5 % de Mg): cambiar 01131 por 01125, obsérvese la reducción en la resistencia a la cortadura. Más información bajo petición.  
 120° cabeza avellanada: cambiar 01131 por 01132 para espesores a remachar equivalente. Las dimensiones A, B y C pueden variar. Más información bajo petición.

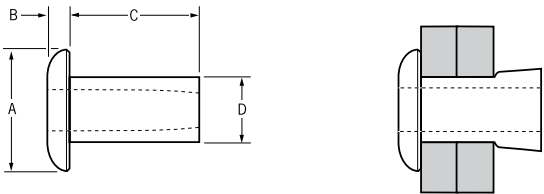

ø	Ø		Ø		A	B	C	D	lb <sup>f</sup> )	Fasteners per pod/ Nombre de rivets par chargeur / Niete pro Magazin/ Rivetti per carica- tore / Uds./carga	Part No/ref		
	min.	max.	min.	max.								max.	max.
3/32"	.000	.062	.0980	.1005	.163	.037	.125	.0975	112	73	01131-00304		
	.062	.125					.187					52	01131-00306
	.125	.187					.250					41	01131-00308
	.187	.250					.312					33	01131-00310
	.250	.312					.375					28	01131-00312
	.312	.375					.437					24	01131-00314
	.375	.437					.500					22	01131-00316
	1/8"	.000					.062					.1290	.1315
.062		.125	.187	51	01131-00406								
.125		.187	.250	39	01131-00408								
.187		.250	.312	32	01131-00410								
.250		.312	.375	27	01131-00412								

all dimensions in inches / en pouces / alle Maße in Zoll / in pollici / en pulgadas

1) typical values / valeurs moyennes / typische Werte / Valori tipici / resistencias máximas recomendadas



An Acument™ Global Technologies Company

[www.avdel-global.com](http://www.avdel-global.com)



© 2007 Acument Intellectual Properties, LLC

Chobert® is a trademark of Avdel UK Limited

04a.2007, page 1/2

Data shown is subject to change without prior notice as a result of continuous product development and improvement policy.  
 Your local Avdel representative is at your disposal should you need to confirm latest information.

# Chobert® 1131

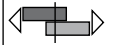
Ø					A	B	C	D		Fasteners per pod/ Nombre de rivets par chargeur / Niete pro Magazin/ Rivetti per carica- tore / Uds./carga	Part No/ref
	nom.	min.	max.	min.	max.	max.	max.	±.007	max.		
5/32"	.062	.125	.161	.164	.257	.058	±.007	.1595	360	47	01131-00506
	.125	.187								38	01131-00508
	.187	.250								31	01131-00510
	.250	.312								27	01131-00512
	.312	.375								23	01131-00514
	.375	.437								21	01131-00516
3/16"	.000	.062	.191	.194	.351	.071	±.007	.1895	450	50	01131-00605
	.062	.125								38	01131-00607
	.125	.187								33	01131-00609
	.187	.250								28	01131-00611
	.250	.312								24	01131-00613
	.312	.375								21	01131-00615
	.375	.437								19	01131-00617
	.437	.500								17	01131-00619
1/4"	.125	.187	.250	.253	.413	.084	±.007	.2485	607	32	01131-00809
	.187	.250								27	01131-00811
	.250	.312								24	01131-00813
	.312	.375								21	01131-00815
	.375	.437								19	01131-00817
	.437	.500								17	01131-00819
	.500	.562								16	01131-00821
	.562	.625								14	01131-00823
	.625	.687								13	01131-00825

all dimensions in inches / en pouces / alle Maße in Zoll / in pollici / en pulgadas

1) typical values / valeurs moyennes / typische Werte / Valori tipici / resistencias máximas recomendadas



An Acument™ Global Technologies Company

www.avdel-global.com

© 2007 Acument Intellectual Properties, LLC

Chobert® is a trademark of Avdel UK Limited

04a.2007, page 2/2

Data shown is subject to change without prior notice as a result of continuous product development and improvement policy.  
Your local Avdel representative is at your disposal should you need to confirm latest information.