

# Avdelmate® SSLMS

For installation information please refer to the tooling overview and manuals on our website [www.avdel-global.com](http://www.avdel-global.com).  
 Pour les conditions de pose, merci de vous référer à la description de l'outil et aux manuels disponibles sur notre site Web.  
 Angaben zur Verarbeitung entnehmen Sie bitte der Geräteübersicht und den Betriebsanleitungen auf unserer Website.  
 Per informazioni sull'installazione preghiamo consultare i manuali e la panoramica degli attrezzi sul nostro sito web.  
 Para ver información sobre máquinas de colocación, consulte nuestra página web, apartados visión general de máquinas y manuales.

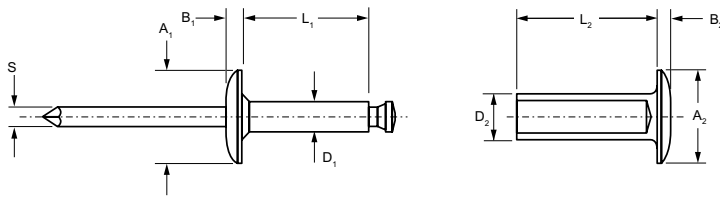

English	Français	Deutsch	Italiano	Español
Body: Steel Zinc plated	Corps: Acier Revêtement zingué	Hülse: Stahl Verzinkt	Corpo: Acciaio Zincati	Cuerpo: Acero Zincado
Mandrel: Steel Zinc plated	Tige: Acier Revêtement zingué	Dorn: Stahl Verzinkt	Gambo: Acciaio Zincati	Vástago: Acero Zincado
Tubular Component: Steel Zinc plated	Composant tubulaire: Acier Revêtement zingué	Röhrenförmiges Gegen- stück: Stahl Verzinkt	Componente tubulare: Acciaio Zincati	Componente tubular: Acero Zincado



ø nom.	[Cross-section diagram]		D <sub>1</sub>	L <sub>1</sub> max.	A <sub>1</sub>	B <sub>1</sub>	S	D <sub>2</sub>	L <sub>2</sub> max.	A <sub>2</sub>	B <sub>2</sub>	[K <sub>N</sub> diagram] kN <sup>1)</sup>	Part No/ref
	min.	max.											
4.8 (3/16")	15.88	19.05	6.4	3.18	13.34	9.53	1.50	1.93	4.78	9.53	1.45	N/A	SSLMS-06SP-12
	17.48	22.23											SSLMS-06SP-14
	22.23	27.00											SSLMS-06SP-17
	27.00	31.75											SSLMS-06SP-20
	31.75	36.53											SSLMS-06SP-23
	36.53	41.28											SSLMS-06SP-26
	41.28	46.05											SSLMS-06SP-29
	46.05	50.80											SSLMS-06SP-32
	50.80	55.58											SSLMS-06SP-35
	55.58	60.33											SSLMS-06SP-38
6.4 (1/4")	15.88	19.05	7.9	11.23	15.88	2.41	2.90	6.35	14.73	15.88	2.41	1.55	SSLMS-08SP-12
	19.05	22.23											SSLMS-08SP-14
	22.23	28.58											SSLMS-08SP-18
	28.58	34.93											SSLMS-08SP-22
	34.93	41.28		SSLMS-08SP-26									
	41.28	47.63		SSLMS-08SP-30									
	47.63	53.98		SSLMS-08SP-34									
	53.98	60.33		SSLMS-08SP-38									
	60.33	66.68		SSLMS-08SP-42									
	66.68	73.03		SSLMS-08SP-46									
	73.03	79.38		SSLMS-08SP-50									
	79.38	85.73		SSLMS-08SP-54									
	85.73	92.08		SSLMS-08SP-58									
	92.08	98.43		SSLMS-08SP-62									

all dimensions in mm / en millimètres / alle Maße in mm / in millimetri / en milímetros

1) typical values / valeurs moyennes / typische Werte / Valori tipici / resistencias máximas recomendadas

